



**Installation guide for the 9 dBi
Panel-directional antenna 1GP-24001**

Directional Panel Antenna

for 2.4~2.5GHz

Version 1

1PG-24001

Electrical Specification:

Frequency	2.4~2.5GHz
Part Number	1PG-24001
Polarization	Linear
V.S.W.R.	1 : 1.5 Max
Impedance	50 OHMS \pm 5 Ω
Gain	9 dBi
Power handling	10W Max
Front to back ratio	15dB
HPBW / horizontal	75 $^{\circ}$
HPBW / vertical	75 $^{\circ}$

MECHANICAL SPECIFICATION

Connector Type	N Type Female
Length	107*90*30mm
Weight	280g
Radome color	WHITE
Radome material	PVC

Directional Panel Antenna

for 2.4~2.5GHz

Version 1

1PG-24001

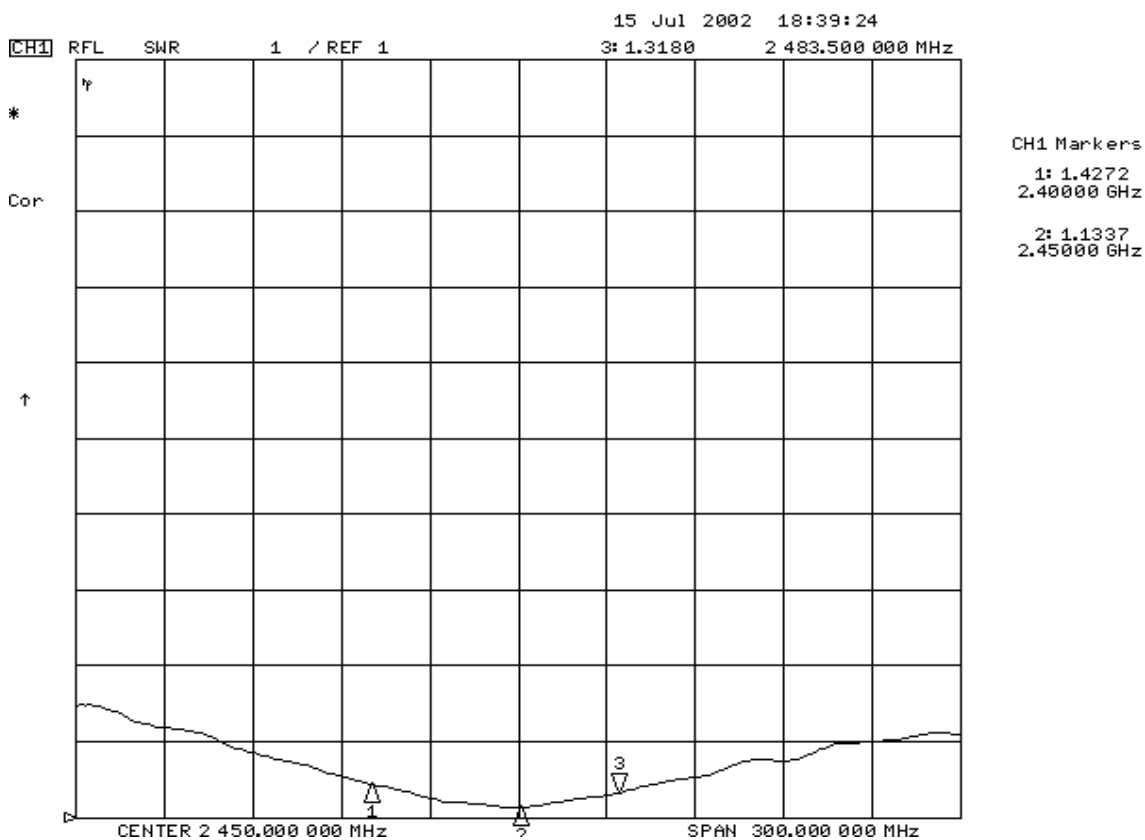
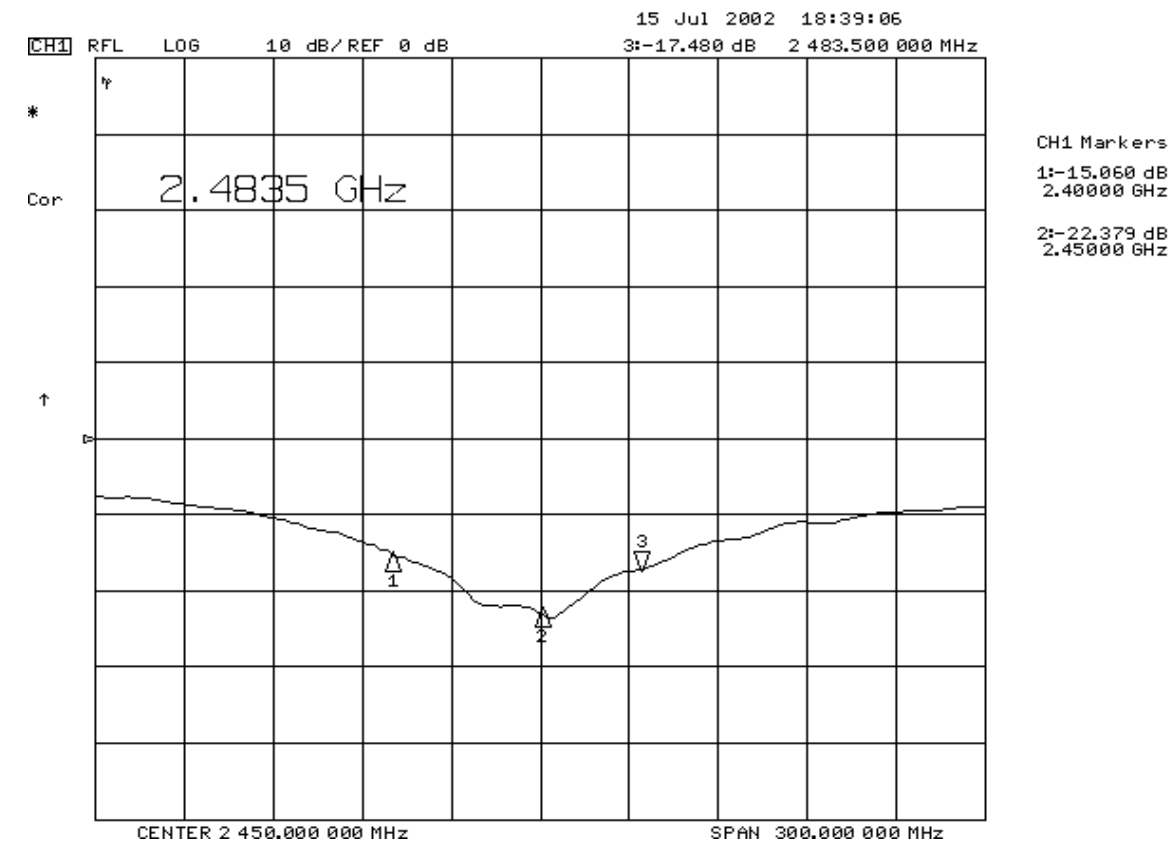

Directional Panel Antenna

for 2.4~2.5GHz

Version 1

1PG-24001

H-PLANE FIELD PATTERNS

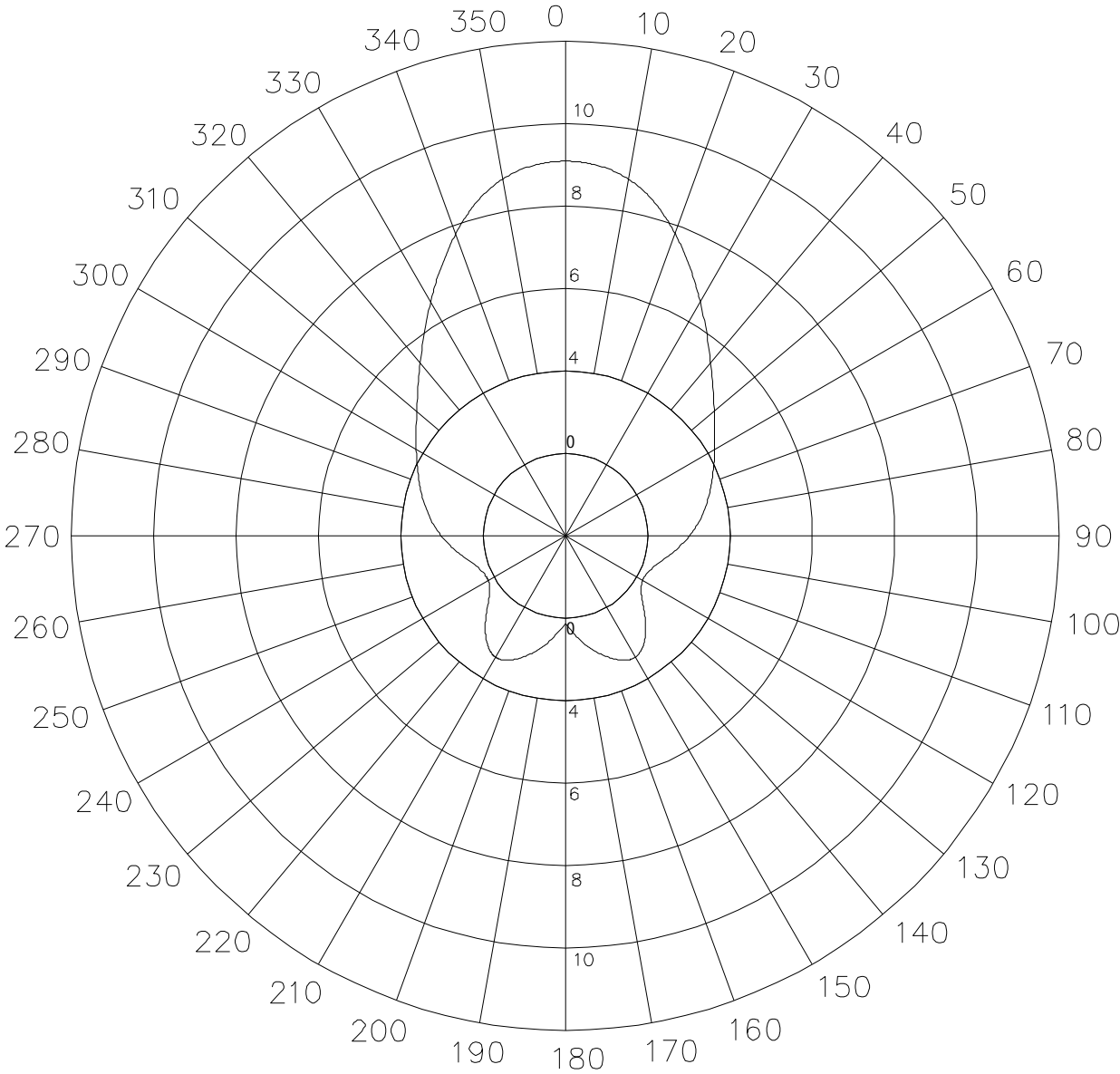

Directional Panel Antenna

for 2.4~2.5GHz

Version 1

1PG-24001

E-PLANE FIELD PATTERNS

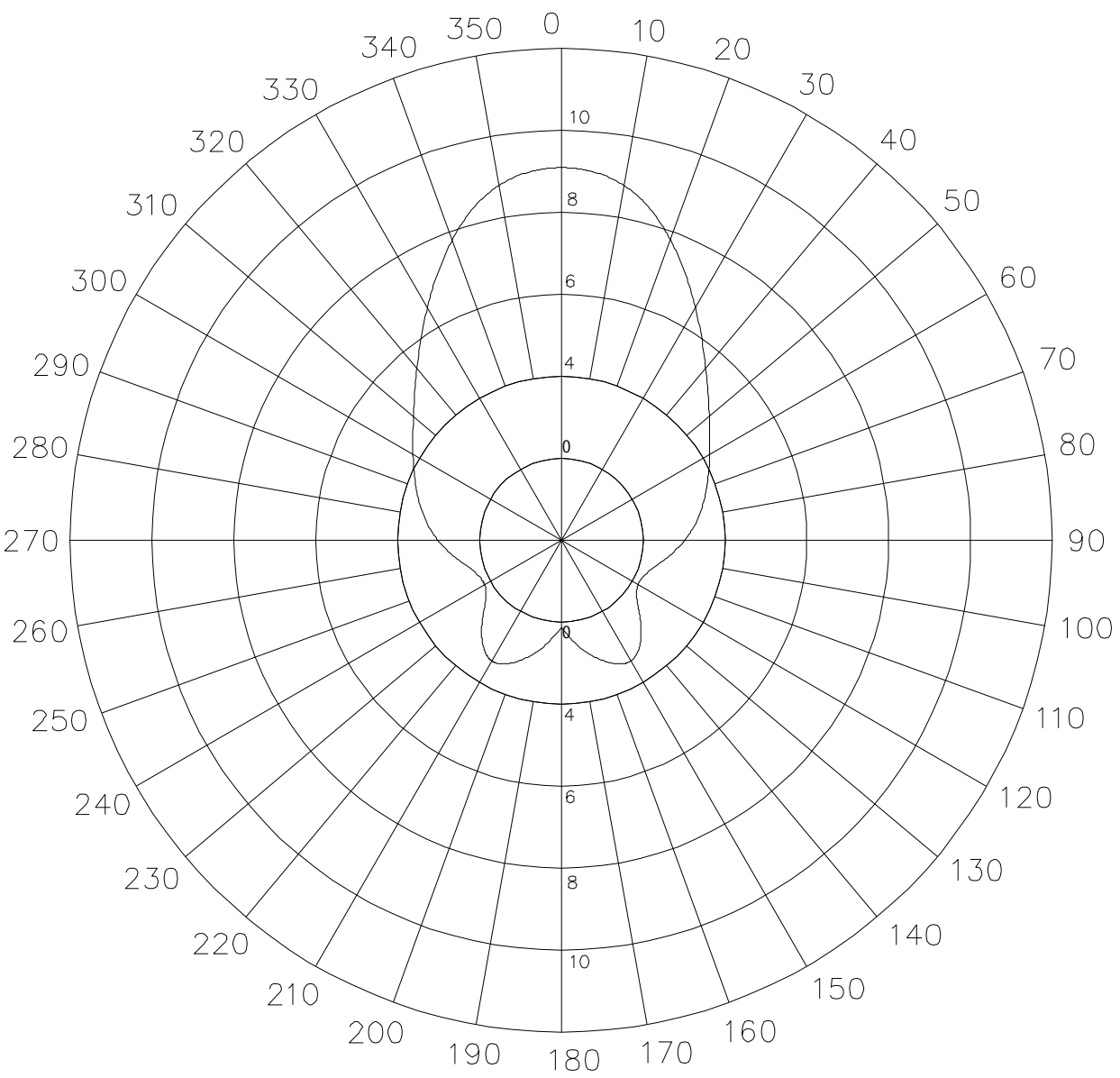

Directional Panel Antenna

for 2.4~2.5GHz

Version 1

1PG-24001

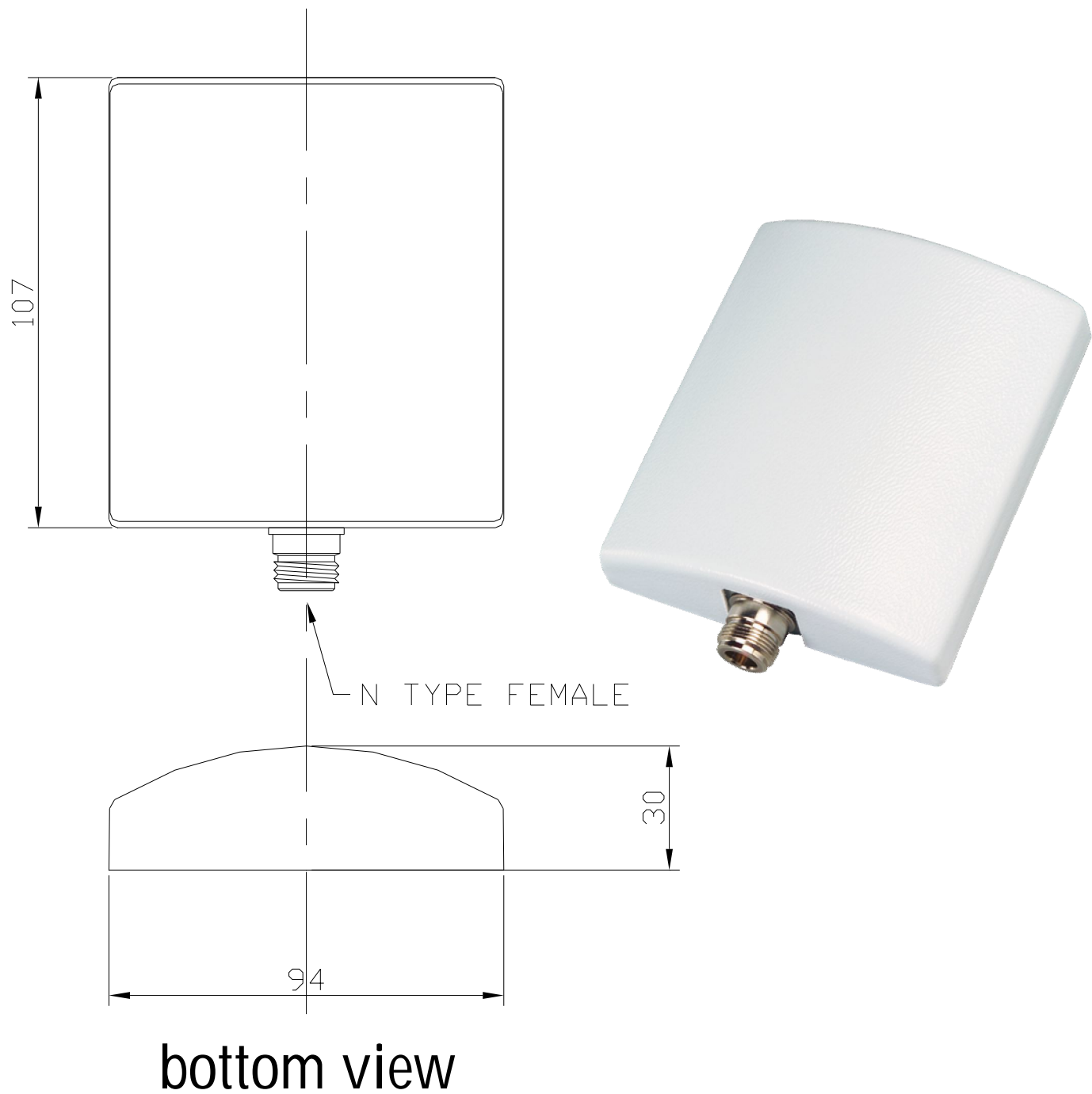

2.4GHz RF HI-GAIN ANTENNA

ITEM NO : 1PG-24001

Fixed support install

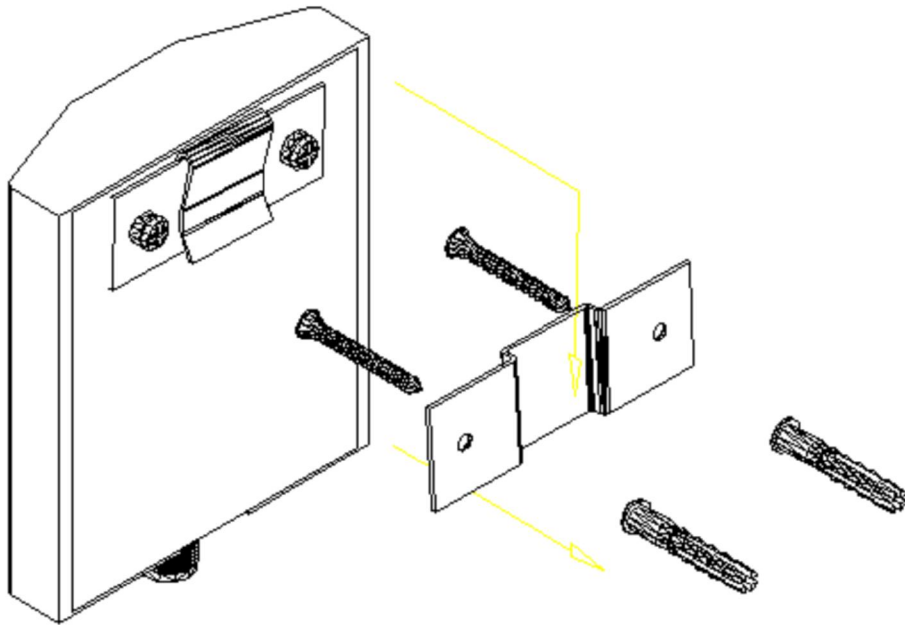

※ SPECIFICATION

- Frequency: 2400~2500 MHz
- Max gain: 9dBi
- Connector: N female
- Max input power: 10W Max
- Wave impedance: 50 OHMS ; 5Ω
- Dimensions: 107*90*30mm
- Weight: 0.28 kg
- For Image/Data/Voice communications and Wireless LAN system.

2.4GHz RF HI-GAIN ANTENNA

ITEM NO : 1PG-24001

Adjustable support install

